

Intergate.East
3311-3511 S. 120th Pl.
Seattle, WA 98168

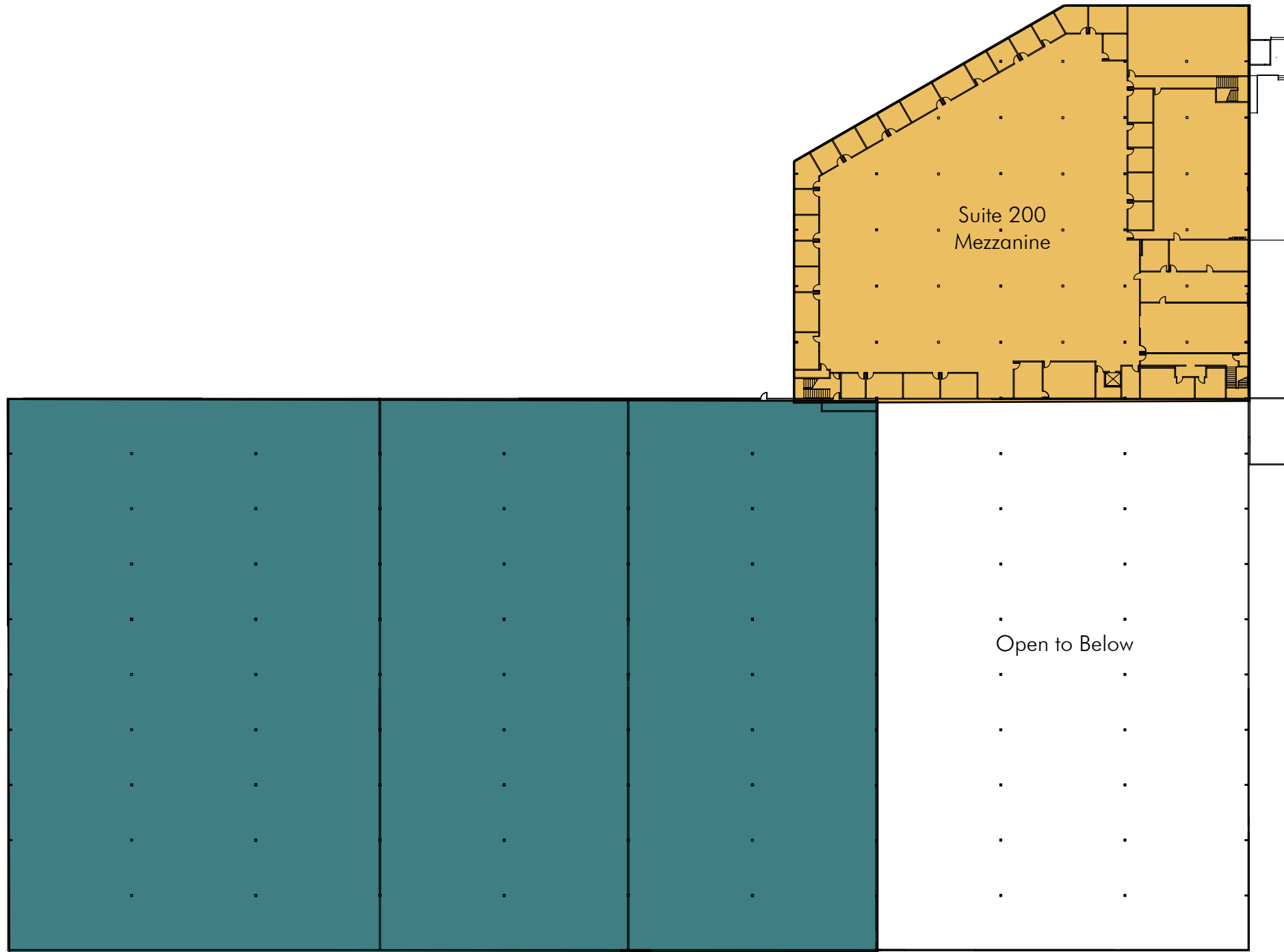

- Common
- Leased
- Available
- SUITE 200
Available Footage: 37,038 sf

M

Building 3 Mezzanine

revised 01/13/07

Intergate.East
3311-3511 S. 120th Pl.
Seattle, WA 98168

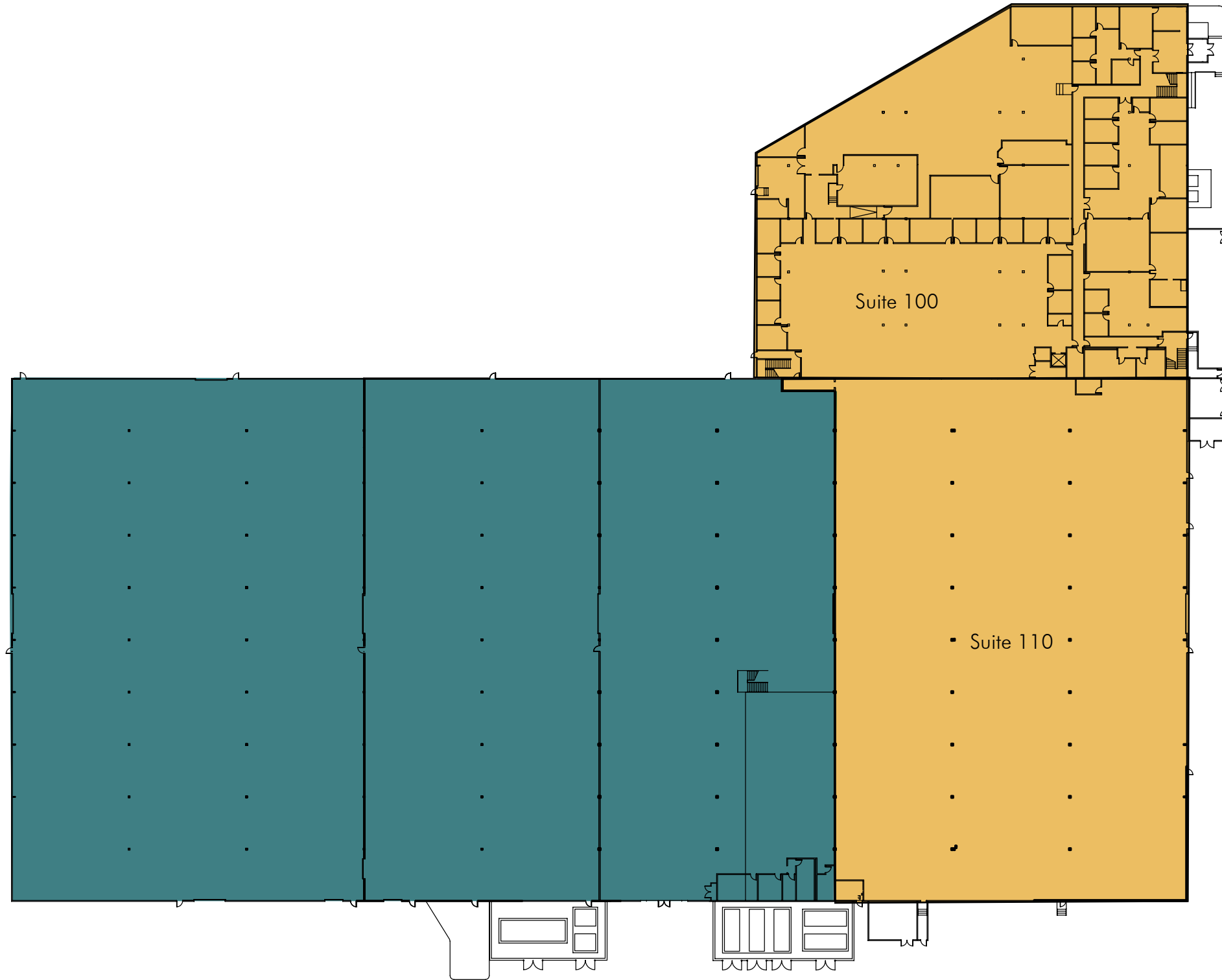

Common

Leased

Available

- SUITE 100
Available Footage: 36,928 sf

- SUITE 110
Available Footage: 47,902 sf

Building 3 First Floor

revised 01/13/07